

Remote Control Guide

Customizing the memory and preset buttons

You can store new bed positions by customizing the preset buttons: Memory buttons M1 and M2, and Zero Gravity. These can be reprogrammed with your desired positions at any time. For safety reasons, the Anti Snore and Flat buttons cannot be customized.

- 1 Move the head and/or foot sections to your desired position using the head and foot adjustment buttons.
- 2 Press and hold the memory or preset button that you want to customize for 5 seconds or until the remote backlight flashes. The new bed position is now stored in your selected preset button overriding the factory default.

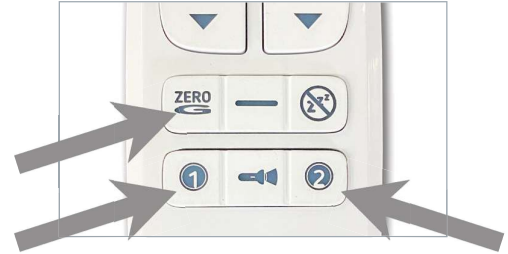

To restore the presets to their factory settings, refer to *Resetting your system*.

Synchronizing two bases for tandem operation

To operate two adjustable bases simultaneously, pair both bases (Base A and Base B) to one remote control (Remote A).

- 1 Plug both Base A and Base B to working electrical outlets. A surge protector is recommended.
- 2 Press the **FLAT** button on Remote A and Remote B to align the bases properly in a flat position.
- 3 On Base B, unplug the power cord from the outlet and then plug it back in. The LED light on the control box turns green and the control box is in pairing mode for 10 seconds.
- 4 On Remote A, press and hold the **FOOT UP ▲** and **FOOT DOWN ▼** buttons at the same time. The remote backlight flashes and starts the sync process.

If sync is successful, the LED light on the control box turns to off immediately and the remote control backlight is blinking. Base A and Base B can now be operated at the same time using Remote A.

- 5 To remove synchronization, perform a standard pairing process by re-establishing the connection between Remote A and Base A. Refer to *Pairing your remote control to your adjustable base*.



NOTE: When operating bases in tandem, both bases should be plugged into a working electrical outlet.

Remote Control Guide

Resetting your system

Resetting the system is sometimes necessary to restore any customizations on the preset buttons to its factory settings.

On the remote control, press and hold the **ZERO G** and **FLAT** buttons for 5 seconds until the remote backlight flashes.

All customized settings on the remote control are now restored to their default settings.

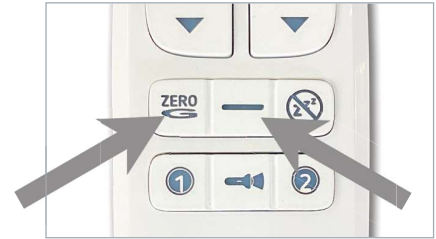

Special Function

Activating the emergency power down feature

The power supply unit on your adjustable base supports the emergency power down feature if a power failure occurs while the head, lumbar, and/or foot sections are raised.

NOTE: Install the 9V batteries in the power supply unit only during a power failure when the emergency power down function is needed.

- 1** Locate and remove the cover on the 9V battery compartment in the power supply unit.
- 2** Install two (2) alkaline 9V batteries (not included with the adjustable base). Replace the battery cover.
- 3** When the 9V batteries are installed and a power failure occurs, press the **FLAT** button on the remote control for the base to return to a flat position.

NOTE: The 9V batteries are for single use only. After lowering the adjustable base once during a power failure, replace with a new set of batteries.

